

UNDERCOVER LED KIT
USER MANUAL



CONTENTS



LIGHT ASSEMBLY INSTALLATION

- 1. Remove the Corner/Head/Tail light from vehicle.
- 2. Select location to mount lighthead.
- 3. Drill 1 inch diameter hole to the light assembly.
- 4. Insert lighthead into hole.
- 5. Apply silicone (user-supplied) for better fit.

WARNING: Do NOT cover heat sink with silicone. It may cause damage to the product and void warranty.

OPERATIONS

- To +VDC (fuse @2A) for Color1 activation.....RED
- To Chassis Ground.....BLACK
- To +VDC (fuse @2A) for Color2 activation.....WHITE
- For Synchronization & Flash Patterns.....YELLOW
- Connect YELLOW wires of all Kits together for synchronization
- \*All kits must be set at the same pattern
- For Simultaneous or Split Flash (single head):
  - 1. Apply +VDC to RED and YELLOW wires simultaneously to enter Mode selection; lighthead will display single flash.
  - 2. Remove YELLOW wire from +VDC and momentarily apply to +VDC to change Mode: Mode1 = Simultaneous Flash, Color1 and Color2 LEDs flash together. (default)
  - Mode2 = Split Flash, Color1 LEDs alternate with Color2 LEDs.

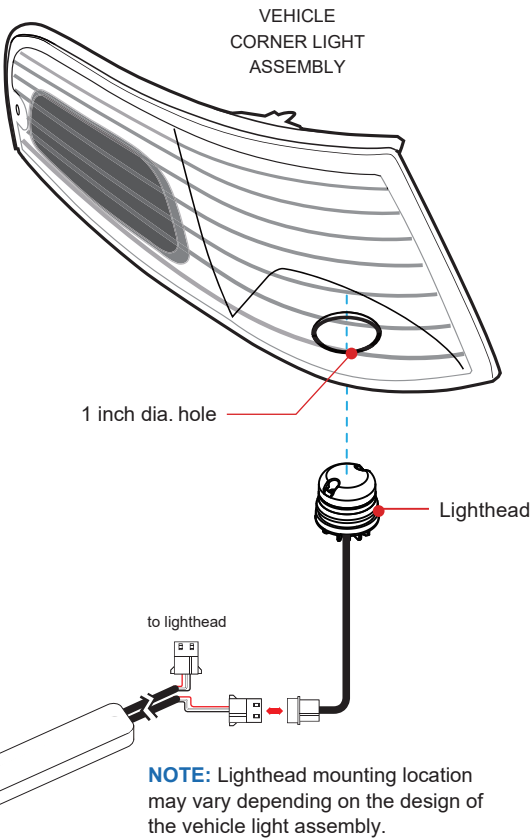

Mode1 (Simultaneous Flash) (Suitable for Single-Color Heads)		Flash	Head1		Head2	
Flash Patterns #1~9	Color1 & 2 flash together, Head1 alternate Head2		Color1	Color2	Color1	Color2
		1st	on	on	off	off
		2nd	off	off	on	on
		1st	on	on	on	on
		2nd	off	off	off	off
		1st	on	on	on	on
		2nd	on	on	off	off

Mode2 (Split Flash) (Suitable for Split-Color Heads)		Flash	Head1		Head2	
Flash Patterns #1~9	Color1 alternate Color2		Color1	Color2	Color1	Color2
		1st	on	off	off	on
		2nd	off	on	on	off
		1st	on	off	on	off
		2nd	off	on	off	on
		1st	on	on	on	on
		2nd	on	off	on	off

For Flash Pattern change, momentarily apply +VDC to YELLOW wire: · once for next pattern · quickly three times for reset

Flash Patterns			
1	Random	11	Double (all)
2	Single (split)	12	Quad (all)
3	Double (split)	13	Quint (all)
4	Quad (split)	14	Mega (all)
5	Quint (split)	15	Ultra (all)
6	Mega (split)	16	Single-Quad (all)
7	Ultra (split)	17	Single H/L (all)
8	Single-Quad (split)	18	Steady Half
9	Single H/L (split)	19	Steady All
10	Single (all)		

NOTE: This unit may not be factory set at FP# 1.



## FLANGE MOUNT INSTALLATION (for kits with Flange option only)

1. Remove Original Base Plate from lighthead base.

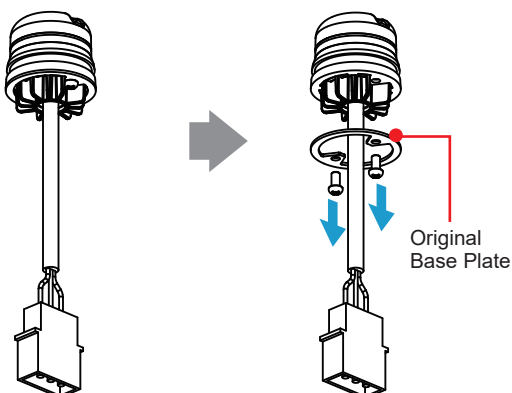

2. Secure Flange Plate to lighthead base with screws.

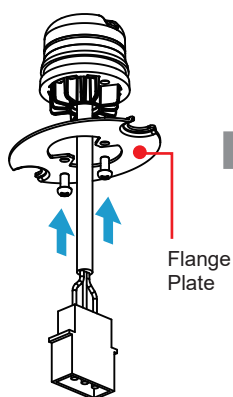

3. Use mounting flange to mark wire and screws holes to drill.
4. Drill marked holes accordingly.
5. Insert lighthead pigtail into wire hole.
6. Place foam, lighthead, and flange in line with the mounting holes, and secure with supplied sheet metal screws.

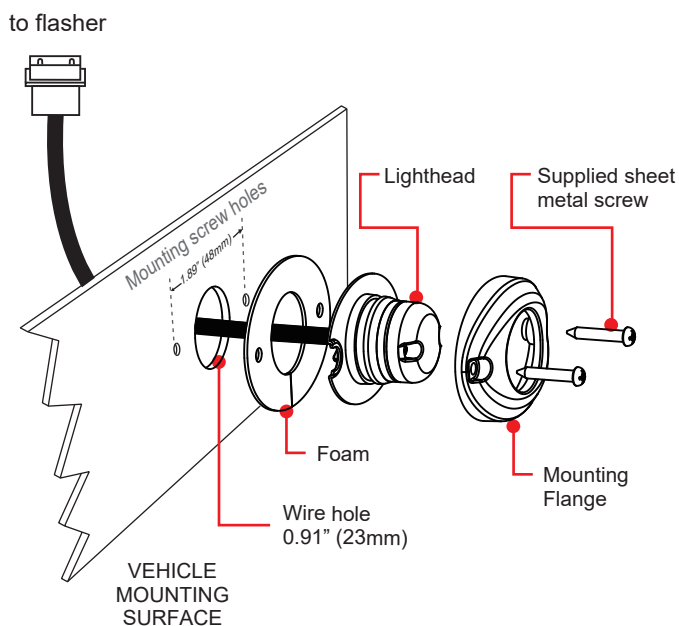

**WARNING:** Make sure to use the foams when mounting lighthead.

## WIRING TO EXISTING STROBE CABLES

In this configuration, existing strobe extension cables are used to facilitate installation.

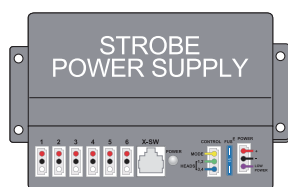

1. Disconnect strobe extension cables from strobe power supply.

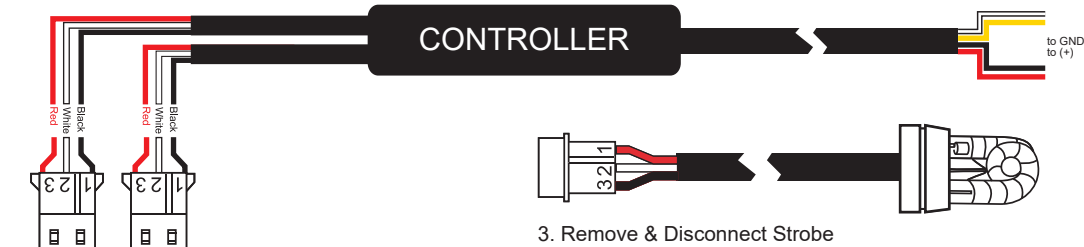

2. Connect LED Kit connectors to strobe extension cables.

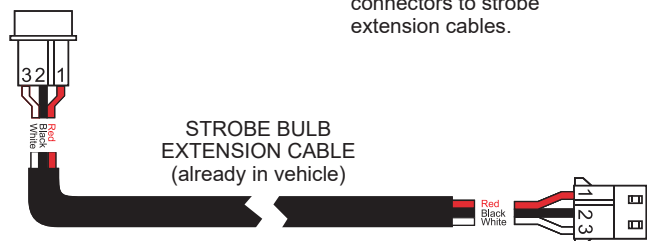

**NOTE:** Wire colors of LED Kit do not need to match wire colors of extension cables.



3. Remove & Disconnect Strobe bulbs from extension cables.



4. Insert & Connect LED Lighthead to strobe extension cables.

**WARNING:** Do not connect LED lighthead directly to strobe power supply. It will cause damage and void the warranty.

